

TOLERANCES acc. to ISO / TOLERANSEN ent. ISO Applicable where no tolerance is indicated. Göller där tolerans ej direkt utformats For machining / For bearbetning ISO 2768-mk For welding / For svejtning SS-EN ISO 13920-BF Surface finish acc. to ISO 15622 Machine surfaces Ytjämnhet enligt ISO 1302. För bearbetade ytor.	Rev. No	Revision description	Date	Sign
	a	Changed fasteners of the electrical box.	10/12/2020	MS

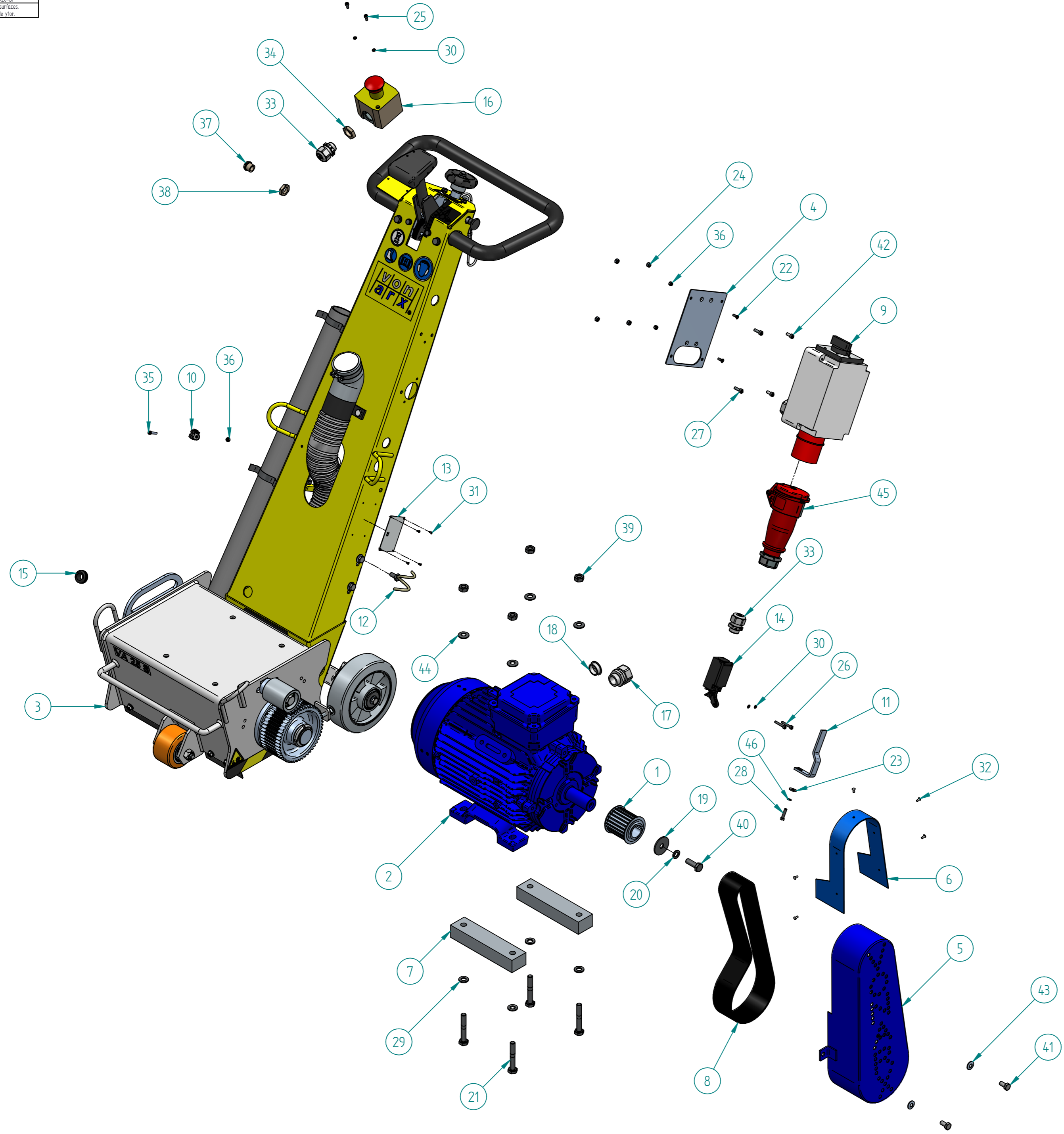

Item	Artikelnummer	Document Number	Title	Quantity
1	701535	628.0103	TOOTHED PULLEY	1
2	109446	633.0305	ELECTRIC MOTOR TYPE A 112M	1
3	702345	644.00.00	VA-25S BASIC DEVICE	1
4	706113	644.20.01c	PLATE	1
5	702377	644.21.03c	BELT GUARD	1
6	706203	644.21.05e	ADDITIONAL BELT GUARD	1
7	702533	654.21.01b	DISTANCE BAR	2
8	702559	654.24.04	TOOTHED BELT 840-8MGT3-50	1
9	702737	655.13.00c	SWITCH ASSEMBLED VA 25 S + VA 30 S	1
10	702747	655.21.08	PIPE CLAMP WITH PROTECTION	1
11	703037	665.09.08a	BEVELLED PROFIL FOR SWITCH	1
12	707069	665.21.06	CABLE GUIDE	1
13	703559	788.42.31d	TYPE PLATE	1
14	114997	791.38.39	POSITION SWITCH	1
15	109046	791.46.54	CABLE RETAINER	1
16	110942	791.80.04	CASING EMERGENCY STOP	1
17	114814	791.80.52	SCREWED CABLE GLAND M25 PLAST	1
18	114816	791.80.54	BLANK PLUG KS M25	1
19	108540	792.62.21	WASHER	1
20	104715	BN_762_M10	SPRING RING BN 762 M10	1
21	110538	792.66.47	HEXAGONAL SCREW	4
22	108652	792.68.21	COUNTERSUNK SCREW	2
23	108573	BN_733_M5	WASHER	1
24	106665	BN_161_M5	SAFETY NUT	4
25	101590	BN_3_M4x10	ALLEN SCREW	2
26	102271	BN_3_M4x25	ALLEN SCREW	2
27	100595	BN_3_M5x16	HEXAGON SOCKET HEAD CAP SCREW	2
28	107683	BN_56_M5x20	HEXAGON HEAD SCREW	1
29	106300	BN_715_M10	WASHER	4
30	100615	BN_792_M4	SAFETY WASHER	4
31	108214	BN_924_TAP_D320	POP RIVET TAP/D320	4
32	112082		RIVET POP TLP/D429	5
33	114813		SCREWED CABLE GLAND M20 PLAST	2
34	114880		COUNTER NUT M20 PLASTICS	1
35	110955		HEX SOCKET CYL.HEAD SCREW	1
36	108692		SELF-LOCKING HEXAGON NUT M4, DIN 985, FZB	3
37	115136		SELF-SEALING GROMMET	1
38	115137		COUNTER NUT M16	1
39	102287	BN_117_M10	HEXAGONAL NUT	4
40	101608	BN_56_M10x30	HEXAGONAL SCREW	1
41	101599	BN_56_M8x16	HEXAGONAL SCREW	2
42	100594	BN_3_M5x12	ALLEN SCREW	2
43	113918	BN_13292_M8	RIP-LOCK LOCKING WASHER	2
44	113919	BN_13292_M10	SAFETY WASHER	4
45	109462		COUPLING CEE	1
46	102285	BN_792_M5	SAFETY WASHER	1
47	111182		STICKER -CAUTION HIGH VOLTAGE-	2
48	703542		ARROW	1
49	700603		TUBE MOLYKOTE BR2 PLUS	0.005
50	900042		LOCTITE 243	0.001
51	109332		CABLE STRAPS	5

Material		Dimension	
Drawn By DD	Date 26/07/2019	Approved Date 10/12/2020	Approved By MS
Units : mm		SIZE A2	
		Description VA 25 S WITH ELECTRIC MOTOR 38	Article Number 706116
		DWG NO 644.20.00a	
Part/Assembly File 6442000.asm		sheet 1	of 1
		Rev. a	

THE INFORMATION CONTAINED IN THIS DRAWING IS THE SOLE PROPERTY OF VON ARX. EOOD. REPRODUCTION IN PART OR WHOLE WITHOUT THE WRITTEN PERMISSION OF VON ARX. EOOD. IS PROHIBITED.